

# Malte Marine Station



**Malte Marine fuel station is designed for safe and environmentally friendly storage and distribution of liquid fuels in the marine sector. It is built in Sweden by SF Pontona, the leading pontoon supplier in the Nordics. The fuel equipment is installed by Malte.**

The marine fuel station is built to meet the strictest regulatory standards for environmental safety and features robust fuel spill containment systems. A leakage sensor monitors the secondary protection offered by the double-walled construction. The station complies with marine environment regulations and can be used in sensitive water catchment areas.

The versatile fuel tanks allow an increased variety of fuel qualities, enabling the provision of niche fuels in economically sustainable quantities. The internal volume of the tanks is 10–40 m<sup>3</sup>, divided into separate 10 m<sup>3</sup> tanks. The 10 m<sup>3</sup> tanks can also be divided into smaller tanks. With unmanned operations and efficient logistics, this marine fuel station meets consumer demands and promotes profitable operations.

Meets the strictest environmental regulations

Movable by road or sea

Flexible fuel tanks

Custom branding

- The 10 m<sup>3</sup> jetty is adapted for road transport. The 20–40 m<sup>3</sup> jetties are adapted for sea transport.
- Malte Marine station meets conforms to environmental requirements NFS2021:10.
- Central filling with integrated fuel containment (150 L), according to land regulations MSBFS2018:3.

### Standard features

- 10 000 l / tank, 1-4 tank
- Sheet metal cisterns painted on the outside with an internal coating 10 cm up
- Aluminum grating
- Stainless steel flex hoses
- Aluminum filling cabinet, with spill tray 150 L
- Electric cabinet
- Manual level gauge
- Leakage detection secondary compartment

### Optional features

- Automatic level measurement
- Canopy
- Hose reel Atex
- Hose reel non Atex
- Stainless grating
- Electric boat charging
- Jerrycan filling box
- DD fender
- Gangway
- Lighting post
- Pumps for transferring black and grey water to land

- Fuel dispensers – Petrotec or customer choice
- Canopy lighting
- 100% internal coating
- Sensors for lightning
- Stainless steel tanks
- Water drainage in the tanks
- Option to divide the tanks with an extra compartment
- D Type Rubber Fender 150 x 150
- Walkways are available in widths of 1.2 and 1.5m and lengths: 4, 6 and 8m. with and without flaps (takes out the level difference between the gangway and the bridge) railings and bracket for suspension.
- Double evercrete treatment surface/walkway
- Pollare/Bollards 1 - 60T
- Anchoring with chain and concrete anchor or pile anchored
- Additional options available upon request

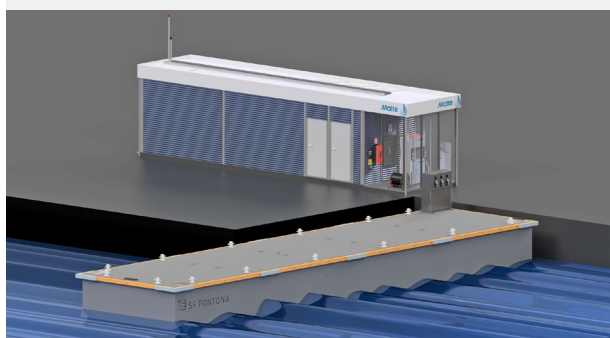

### Dimensions

- Length: 10–25 m
- Width: 4,5–4,7 m